

WILLIAMSBURG, BROOKLYN, NY

28 HERBERT STREET

MOD



SPACE DETAILS

LOCATION

Southwest Corner of Humboldt and Herbert Street

SPACE

Space A: 1,920 SF

~~Space B: 2,270 SF~~

FRONTAGE

133 Feet

POSSESSION

Q2 2025

ASKING RENT

Upon Request

NEIGHBORS

McCarren Park, Brooklyn Steel, The Richardson, FourFiveSix, Carmine's, McDonald's, Chase, Land to Sea, Cozy Royale, Fandi Mata, Lilia

TRANSPORTATION



COMMENTS

- New Development at the base of a 5 story residential building
- Wraparound Frontage
- High Ceilings
- Full Glass Façade
- Dense Residential Neighborhood
- Divisions Considered
- All Uses Considered

CONTACTS

MEYER DAGMY

718-249-3613

m@modcre.com

EDDIE MAMIYE

917-379-6719

e@modcre.com

MIKE SUTTON

917-588-1000

mike@modcre.com



2774 CONEY ISLAND AVE, BROOKLYN, NY 11235

FLOOR PLAN

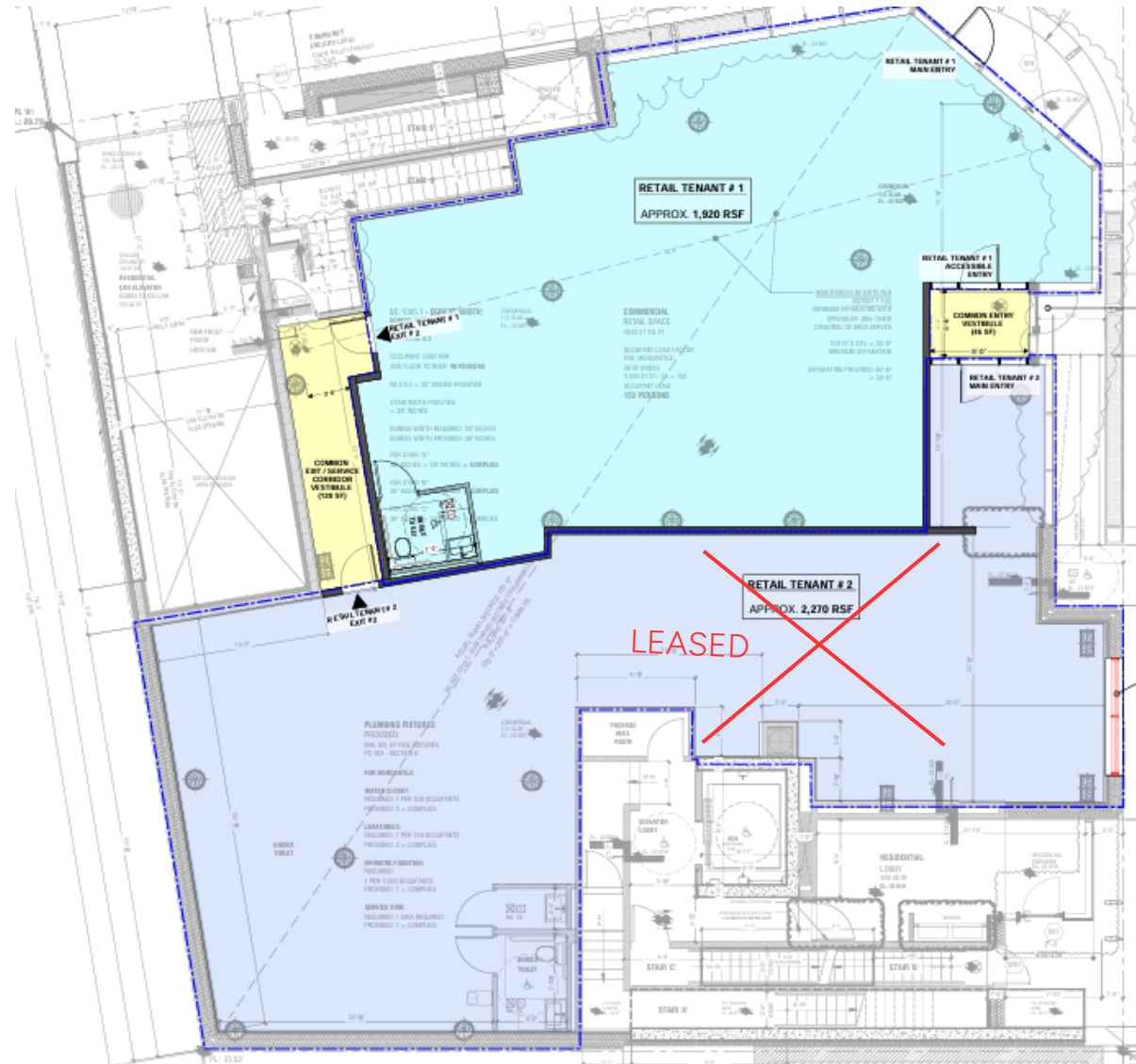

CONTACTS

MEYER DAGMY

718-249-3613
m@modcre.com

EDDIE MAMIYE

917-379-6719
e@modcre.com

MIKE SUTTON

917-588-1000
mike@modcre.com

MOD

AREA MAP



CONTACTS

MEYER DAGMY

718-249-3613
m@modcre.com

EDDIE MAMIYE

917-379-6719
e@modcre.com

MIKE SUTTON

917-588-1000
mike@modcre.com

MOD

2774 CONEY ISLAND AVE, BROOKLYN, NY 11235

© 2024 MOD Commercial Realty LLC. All information provided is deemed reliable, but is not guaranteed and should be independently verified.