

VERADA

15 North 15th Street

Williamsburg

Prime Retail
Opportunity



A prime commercial opportunity in Williamsburg, 15 North 15th Street is an 8,631 SF single-story property with 100 feet of frontage, high ceilings, and street-to-street access. Ideal for flagship retail or light industrial use, the space is surrounded by new development and offers easy access to the Brooklyn waterfront, Bushwick Inlet Park, and major transit options, including the Nassau Ave G train and North Williamsburg Ferry.

[View Listing >](#)



[View Listing >](#)

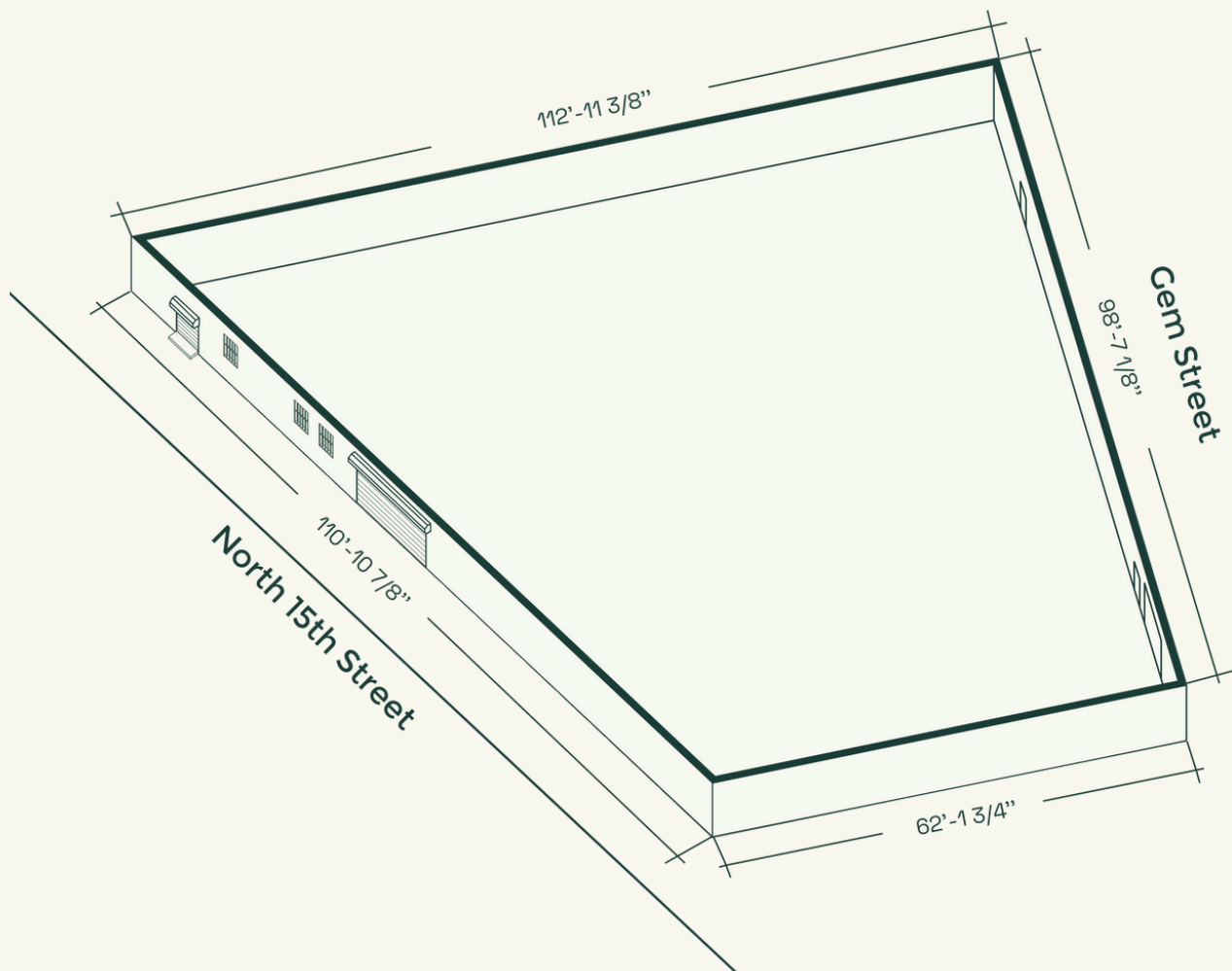

Ground Floor	8,631 SF
--------------	----------

Ceiling Heights	12.6 FT - 14 FT
-----------------	-----------------

Frontage	100 FT
----------	--------

Flexible, Open Layout	Minimal columns
-----------------------	-----------------

Loading Dock	Yes
--------------	-----

Features	Dry Sprinklers Gas Heat
----------	---------------------------

Market Consessions	Ownership will provide market concession for qualified tenant
--------------------	---

Divisible	Yes
-----------	-----

[View Listing >](#)



- Neighborhood Description:**
- Prime Williamsburg Location – Near the Brooklyn waterfront in a growing mixed-use district.
 - New Developments Nearby – Surrounded by major residential and commercial projects.
 - Parks & Recreation – Steps from Bushwick Inlet Park and McCarren Park.
 - Dining & Retail – Close to popular spots like Kith, Vital Climbing Gym, and Allswell, attracting consistent foot traffic.
 - Easy Transit Access – Near the Nassau Ave G train, North Williamsburg Ferry, and multiple Citi Bike stations, ensuring seamless connectivity.

[View Listing >](#)

Nate Mallon
nm@veradaretail.com
 860-416-7288

Brendan Thrapp
bt@veradaretail.com
 201-787-9679

Aidan O'Connor
ao@veradaretail.com
 443-537-8114

VERADA
veradaretail.com